

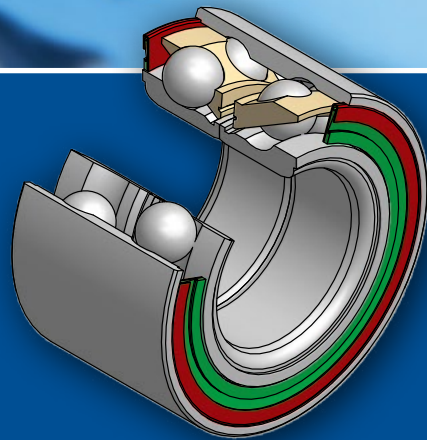

SPECIAL BEARINGS
AND SPECIAL ANGULAR CONTACT BEARINGS



SPECIAL BEARINGS

Special rolling bearings have non-standardized dimensions or design, eventually both. They are used for arrangements, where the designer because of various reasons cannot use standardized standard or modified bearings.

These bearings are used as relieving pulleys in various machines, instruments and devices or they are used for arrangements in various branches of industry.

Specific group of special angular contact bearings are bearings for clutches that form integrated units to control the clutch. Special rolling bearings can be also used in other arrangements than originally intended for.

All technical specifications and other data necessary for calculation and arrangement of special rolling bearings are specified in the dimension tables.

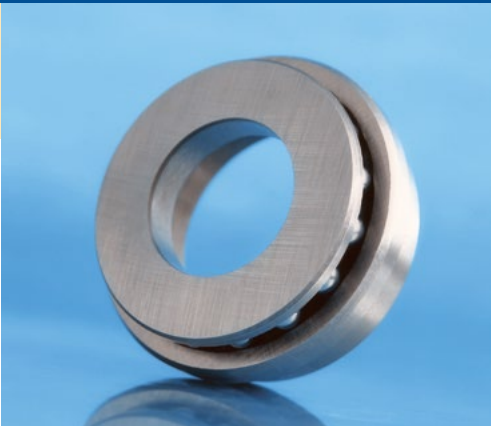

DESIGN SPECIFICATIONS

DESIGNATION

The designation of special single row ball bearings corresponds with the designation method of special rolling bearings, e.g.: PLC 03-80, where the symbol "PLC" is a common symbol for special rolling bearings, numerical character "0" stands for design group of single row ball bearings and other numerical character (1-12) dimension group according to outer diameter of the bearing. Numeric character behind the dash is the ordinal number in the corresponding dimension group. Non-standardized dimensions apart from the further shown exceptions are designated according to the following scheme:

DESIGNATION SCHEME OF NON-STANDARDIZED BEARINGS

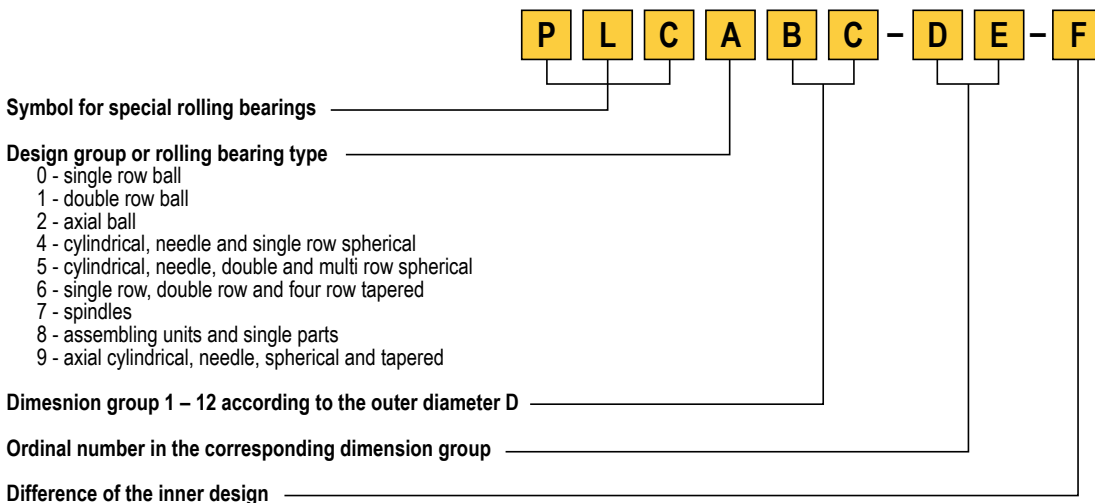

SPECIAL BEARINGS

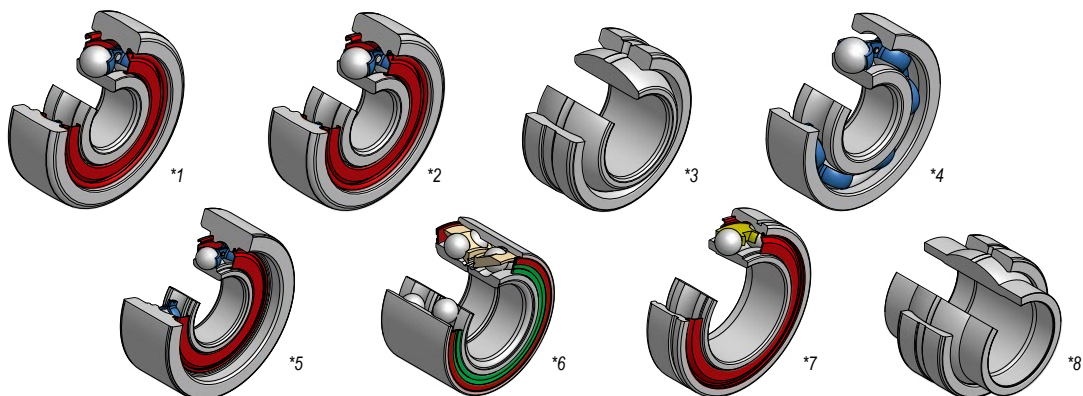

Dimensions mm							Basic Load Rating kN		Limiting Speed for Lubrication min ⁻¹		Bearing Designation	Weight kg	Pict.
d	D	B	C	R	r _s min	r _{1s} min							
12	36	10	11,9	60	0,6	1	6,905	3,1	22000	-	PLC 03-80	0,059	*1
12	36	10	12	-	0,6	-	6,905	3,1	22000	-	PLC 03-222	0,060	*2
19,05	36,51	15,06	19,05	-	0,6	-	46	238	-	-	PLC 32-600	0,119	*3
20	51	15	-	-	1,1	-	16	7,94	14000	17000	PLC 04-30	0,126	*4
30	74,2	16	28	-	1	0,6	19,6	11,2	11000	-	PLC 05-13	0,545	*5
30	68	37	-	-	0,5	2,2	39,8	38,3	6500	-	PLC 15-12	0,530	*6
30	62	16	18	-	1,5	0,8	15,956	10,328	10600	12600	PLC 04-208	0,160	*7
40	68	60,5	28	-	1	0,3	127	640	-	-	PLC 33-200	0,654	*8

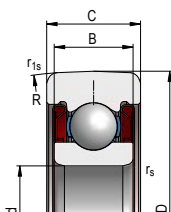

*1 - When using the bearing as relieving pulley the values for load rating Cr, Cor and limiting rotation speed are decreased on 2/3 of the values specified in the table.

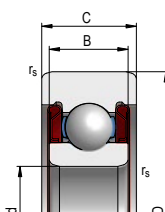

*2 - Bearing with metal cage covered on both sides and with radial clearance Gr 0,065 to 0,075 mm.

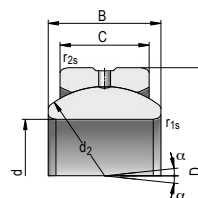

*3 - Spherical bearing with radial clearance Gr 0,040 to 0,082 mm.

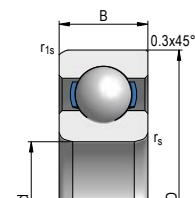

*4 - Ball bearing with metal cage and radial clearance Gr 0,005 to 0,020 mm.

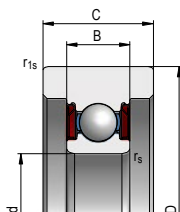

*5 - Special ball bearing covered by metal shields and with extended outer ring, with radial clearance Gr 0,005 to 0,020 mm.

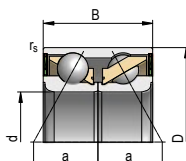

*6 - Double row angular contact ball bearing, sealed, for arrangement on the front wheel of a car.

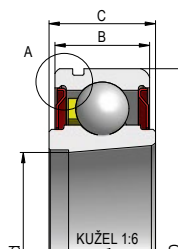

*7 - Single row ball bearing with tapered bore, sealed on both sides, filled with plastic lubricant, with radial clearance Gr 0,005 to 0,020 mm.

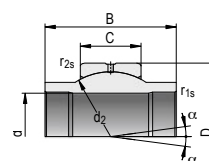

*8 - Special spherical bearing with extended inner ring with radial clearance Gr 0,20 to 0,35 mm.

SPECIAL SINGLE ROW ANGULAR CONTACT BALL BEARINGS

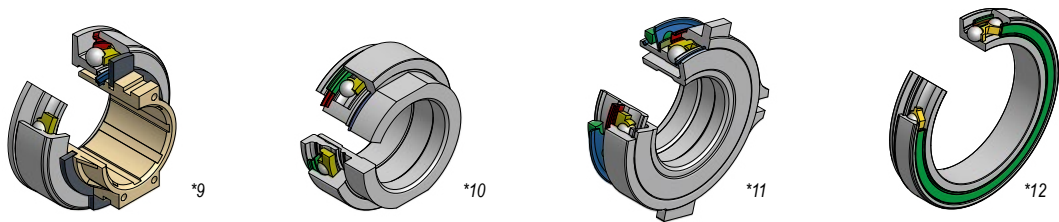

Dimensions mm								Basic Load Rating kN		Limiting Speed for Lubrication min ⁻¹		Bearing Designation	Weight kg	Pict.
d	D	T	d ₁	d ₂	d ₃	B	T ₁							
45,2	94,5	50,5	95	57	-	16	21	20,3	16,3	5300	-	PLC 06-204	0,780	*9
68	115	58	102	76,4	-	55	39	27,6	23,3	4200	-	KZI-5	1,420	*10
68	128	51	106	90	100	42,5	33,5	33,5	27,6	4000	-	KZI/Z-5/T	1,880	*11
106	145	-	138	-	-	18	25	23,8	24,3	2500	-	PLC 08-13	0,940	*12

